

SELECTOR CONTROLS (AUTOMATIC TRANSMISSION)

Part No.	Description	Plate No.	No. per Unit	Remarks
432438	SELECTOR QUADRANT ASSEMBLY	17—1	1	
0810/16	Bush, in Quadrant		1	
UCS.131/5R	Screw, Set, securing Quadrant to Transmission Unit Mounting Bracket		3	
FG.105/X	Washer, Spring, on Setscrews		3	
136454	COVER FOR QUADRANT ASSEMBLY	17—2	1	
UCS.525/8H	Screw, Set, securing Cover to Quadrant		1	
UCS.525/10H	Screw, Set, securing Cover to Quadrant		2	
423145	Lockwasher, on Setscrews		3	
307192	SELECTOR HAND LEVER	17—3	1	
430195	Knob, on Selector Lever	17—4	1	
430199	Nut, securing Knob to Lever	17—5	1	
430194	Pivot Pin, securing Selector Lever to Boss on Operating Lever	17—6	1	
UFN.119/L	Nut, securing Pivot Pin		1	
C.723/A	Washer, Shakeproof, under Nut		1	
308734	BOSS ON OPERATING LEVER	17—7	1	
422510/10	Key, locating Boss on Operating Lever	17—8	1	
UFN.137/L	Nut, securing Boss to Operating Lever		1	
FG.106/X	Washer, Spring, under Nut		1	
430200	Spring, tensioning Selector Hand Lever	17—9	1	
430242	Stop Plate, for Selector Hand Lever	17—10	1	
430243	Packing (Fibre) under Stop Plate	17—11	1	
906049	Screw, Set, securing Retaining Plate to Boss		2	
432420	OPERATING LEVER, IN QUADRANT ASSEMBLY	17—12	1	
432943	Wavy Washer, between Operating Lever and Quadrant	17—13	1	
426768	Ball Pin, in Operating Lever for Control Rod	17—14	1	
UFN.125/L	Nut, securing Ball Pin		1	
432922	CONTACT ADJUSTER ON OPERATING LEVER, FOR STARTER SOLENOID CUT-OUT	17—15	1	
NN.121/L	Nut, securing Contact Adjuster to Operating Lever		1	
308374	SWITCH IN QUADRANT, FOR STARTER SOLENOID CUT-OUT	17—16	1	
C.730	Washer, Shakeproof, on Switch		1	

SELECTOR CONTROLS

(AUTOMATIC TRANSMISSION)

Part No.	Description	Plate No.	No. per Unit	Remarks
422542/6	CONTROL ROD, BETWEEN OPERATING LEVER AND BELL CRANK LEVER	17—17	1	
426767 UFN.125/L FG.104/X	Ball Socket, on Control Rod Nut, securing Ball Sockets to Rod Washer, Spring, under Nuts	17—18	2 2 2	
432480	BELL CRANK LEVER ASSEMBLY, ON TRANSMISSION UNIT MOUNTING BRACKET	17—19	1	
0608/16	Bush, on Bell Crank Lever		1	
432942 C.8667/1 FW.104/T	Wavy Washer, between Bell Crank Lever and Bracket Nut, securing Bell Crank Lever to Bracket Washer, Plain, under Nut	17—20	1 1 1	
426768 UFN.125/L FG.104/X	Ball Pin, on Bell Crank Lever for Control Rod Nut, securing Ball Pin to Bell Crank Lever Washer, Spring under Nut	17—21	1 1 1	
308736	CONTROL ROD, FROM BELL CRANK LEVER TO SELECTOR LEVER ON TRANSMISSION UNIT	17—22	1	
432436 422531/03 L.102/4U FW.104/T	Fork End, connecting Control Rod to Bell Crank Lever Clevis Pin, securing Fork End to Bell Crank Lever Split Pin, retaining Clevis Pin Washer, Plain, behind Split Pin	17—23 17—24	1 1 1 1	
426767 UFN.125/L	Ball Socket, connecting Control Rod to Selector Lever on Transmission Unit Nut, securing Fork End and Ball Socket to Rod	17—25	1 2	
426768	BALL PIN, ON TRANSMISSION UNIT SELECTOR LEVER	17—26	1	
UFN.125/L FG.104/X	Nut, securing Ball Pin Washer, Spring, under Nut		1 1	
308765	LEATHER GAITER, FOR QUADRANT ASSEMBLY	17—27	1	
432444 426934/22 AG.104/X	Fixing Plate (Inner) securing Gaiter to Quadrant Screw, securing Fixing Plate to Quadrant Washer, Spring, on Screws	17—28	1 8 8	
308763 425285/17	Fixing Plate (Outer) securing Gaiter Screw, securing Fixing Plate to Gearbox Cover	17—29	1 10	

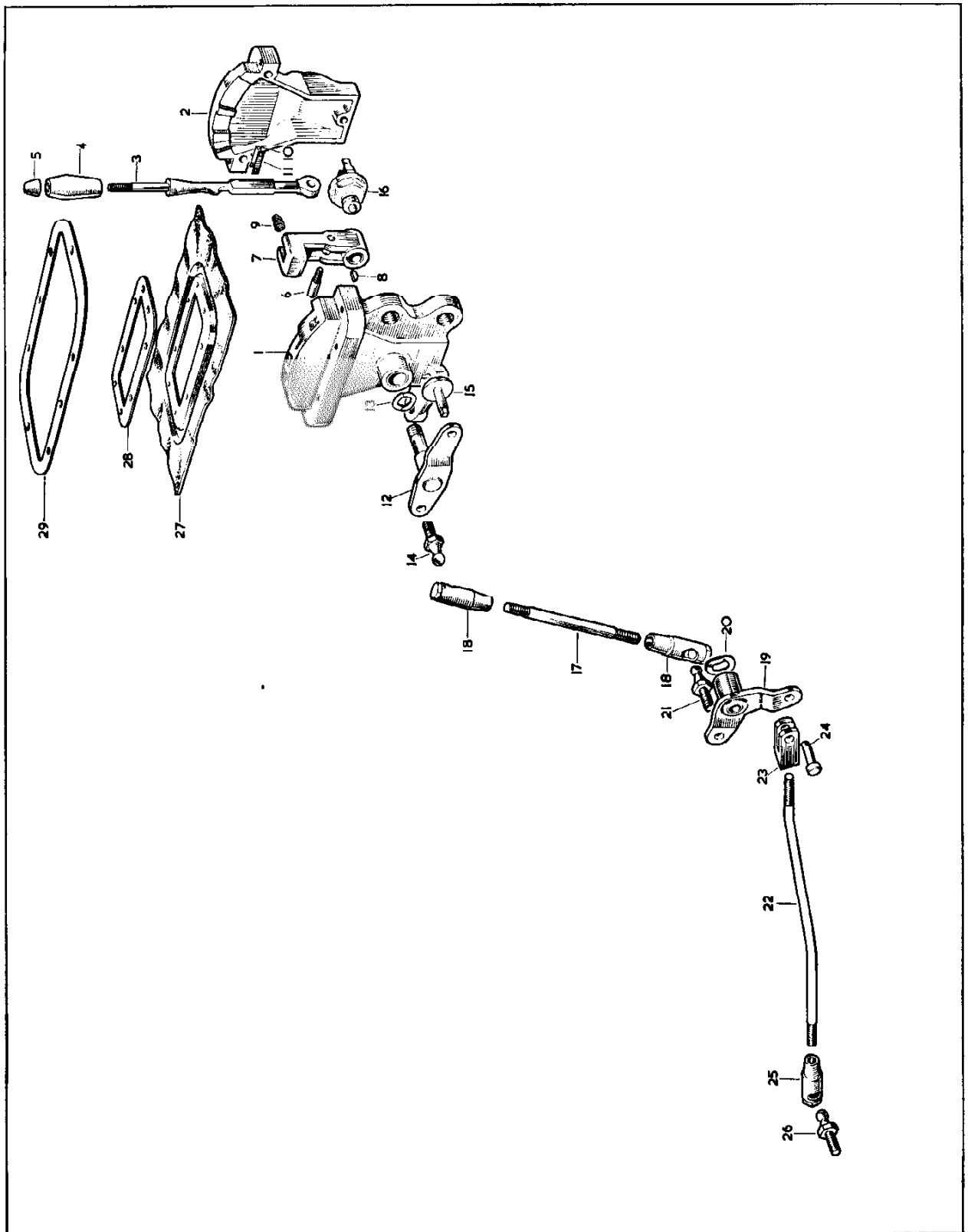

PLATE 17