

PROPELLER SHAFT

Part No.	Description	Platc No.	No. per Unit	Remarks
302150	PROPELLER SHAFT ASSEMBLY	18—1	1	FOR USE ON CARS FITTED WITH STANDARD TRANSMISSION ONLY
12	Flange Yoke (K2/2/239)	18—2	2	
13	Sleeve Yoke (K2/3/68)	18—3	1	
26	Dust Cap, for Sleeve Yoke (3/14/39)	18—4	1	
28	Washer, (Cork) in Dust Cap (K3/16/43)	18—5	1	
27	Washer, (Steel) in Dust Cap (K3/15/33)	18—6	1	
8406	Grease Nipple, on Sleeve Yoke (94/GB.2204)	18—7	1	
46	Journal Assembly, connecting Flange Yokes to Propeller Shaft (K.5/L.4)	18—8	2	
248	Grease Nipple, in Journals (94/GB.1598)	18—9	2	
309289	PROPELLER SHAFT ASSEMBLY		1	FOR USE ON CARS FITTED WITH AUTOMATIC TRANSMISSION ONLY
	Individual items are as for Propeller Shaft Assembly 302150			
430256 C.8667/3	Bolt, securing Propeller Shaft to Gearbox and Rear Axle Nut, on Bolts	8 8	8 8	} STANDARD TRANSMISSION ONLY
430256 C.8667/3	Bolt, securing Propeller Shaft to Rear Axle Nut, on Bolts at Rear Axle	4 4	4 4	
C.8667/3	Nut, on Bolts, in Transmission Unit Flange	4	4	} AUTOMATIC TRANSMISSION ONLY

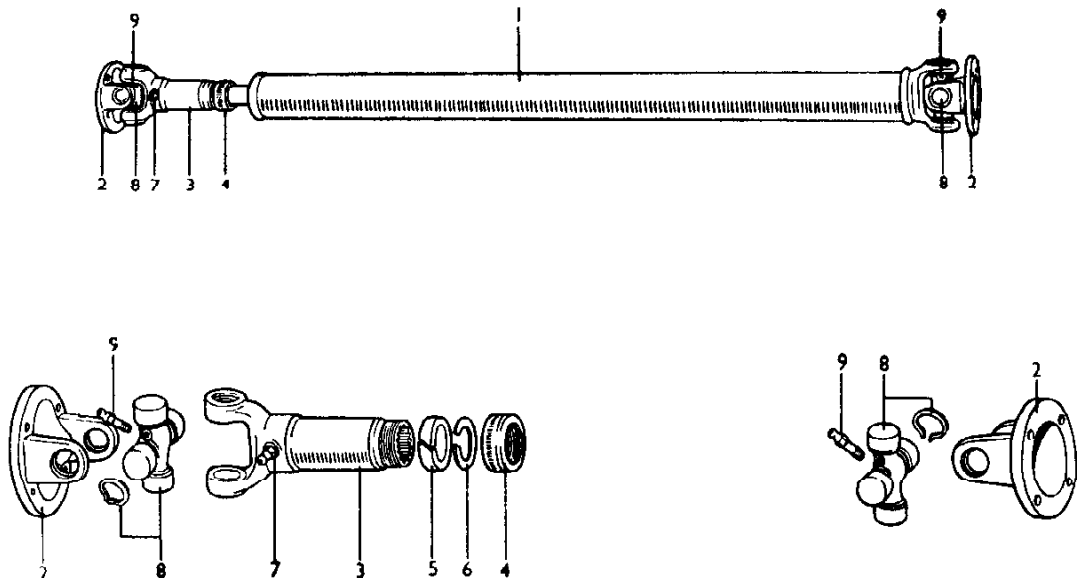

PLATE 18